



item #
model #
project #
sis #
aia #

HOLD HHT161K

Warm holding cabinet

CONSTRUCTION FEATURES

- Tightness chamber with radiuses corners
- All-around rubber bumpers
- Total thermic insulation with rock or glass wood
- Long lasting front seal, made up of food-grade and high-heat resistant silicone
- Removable side racks to facilitate cleaning
- Static heating provided by low consumption wire heating element that coils up all the chamber DELIWARM®
- Ergonomic and fully built-in door handle with magnetic closure
- Four swivel wheels of which 2 with brake
- Ergonomic handle for pushing and guiding
- Easy access to facilitate maintenance and repair

FUNCTIONAL FEATURES

- Electronic capacitive control, temperature, holding cycle, programs, holding by probe*
- Operating temperature 30°-120°C
- Adjustable humidity vents on the door
- Chamber with safety thermostat
- Manual keyboard lock
- Automatic Holding Cycle (*only with Core Probe option)

STANDARD SUPPLY

- Removable GN 1/1 tray racks

OPTIONS & ACCESSORIES

- Core Probe
- Feet kit
- Grids
- Trays
- Opposite side opening
- Uk Plug
- WiFi

MODULINESRL



moduline

TECHNICAL INSTALLATION DIAGRAM

Electricity supply
cable inlet 

Vent for excess
humidity 

Important - Drawing and
dimensions refer to the
standard version.
They may change with
the addition of
accessories
or options.

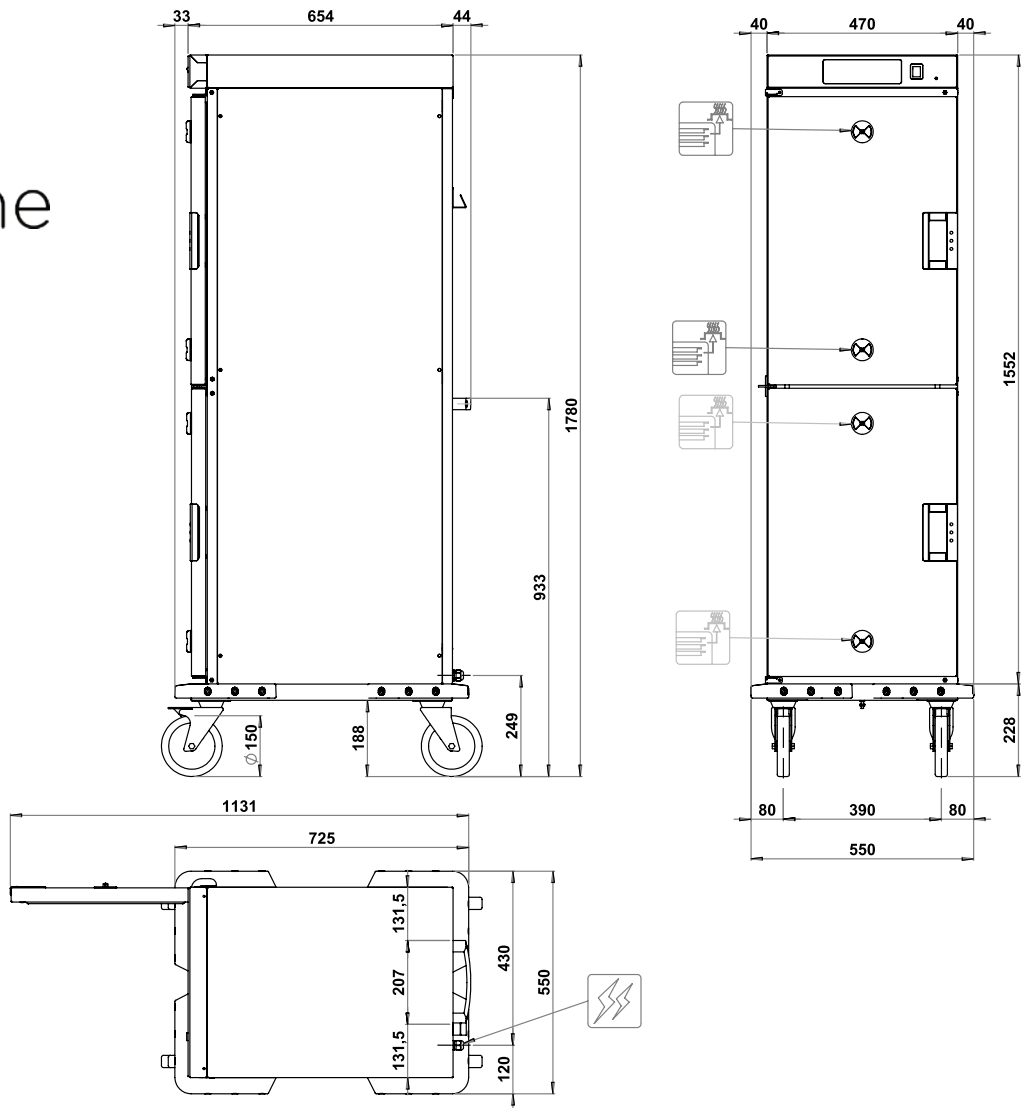

Overall dimensions (W x D x H) - mm	550 x 725 x 1780 h
Trays capacity - distance [mm]	16x GN 1/1 - (75)
Tray max. height [mm]	16 x 65 (h) 6 x 150 (h) 4 x 200 (h) + 4 x 65 (h)
Power supply	AC 220-240V 50/60Hz
Total input [kW]	2 (230V)

Amps. [A]	8,7 (230V)
Working temperature [°C]	30 ÷ 120
Product max capacity [Kg]	58
Net weight [Kg]	88



- A Holding cycle C° or Automatic Holding by Core Probe*
- B Info Display
- C Start / Stop or Preheating
- D Decrease value
- E Programs (Save or Recall)
- F Increase value
- On/Off switch beside the board

MODULINESRL

Via dell'Industria 11, Z.I. San Giacomo di Veglia 31029 Vittorio Veneto (TV) - ITALY
tel. +39 0438 5063 - fax +39 0438 912 323 - info@moduline.it - www.moduline.it